

Santa Fe Ten

MEMORIAL FOUNDATION

COMMUNITY REPORT

SEPTEMBER 2021





CONTENT

03	THE TEN
04	LETTER FROM THE BOARD
05	BOARD OF DIRECTORS & MEMBERS
06	MISSION AND VISION
07	ACCOMPLISHMENTS
08	THE UNFILLABLE CHAIR
14	CAPTURE THE CLASS & GRADUATION
15	SENIOR PARKING SPOTS
16	BIRTHDAY TRIBUTES
17	CONGRESSIONAL MEDAL OF HONOR YOUNG HERO AWARD
18	SANTA FE TEN MEMORIAL
22	LETTER FROM 9/11 MEMORIAL & MUSEUM
23	9/11 SURVIVOR TREE SEEDLING
24	RUN IN REMEMBRANCE 2021
26	FOUNDERS
27	THE FUTURE
28	CONTACT US

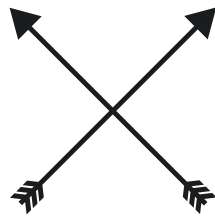

**Jared Conard Black
Shana Fisher
Christian Riley Garcia**



**Kyle McLeod
Ann Perkins
Angelique Ramirez
Sabika Sheikh
Chris Stone
Cynthia Tisdale
KJV**

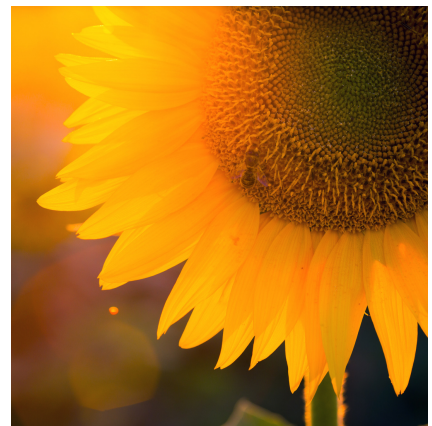
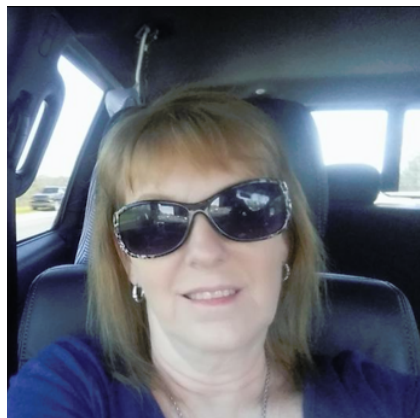

letter from the board



We thank you in advance for your generosity as we continue to find solace and support one another through **COMPASSION** and solidarity. These prove, time and time again, human **DIGNITY** will triumph over human depravity. As will be etched in the center stone of the Memorial, we are “Defined not by a day, but instead by the **STRENGTH** within us.”

Within nine months of incorporation as a nonprofit, the Santa Fe Ten Memorial Foundation completed the concept design of the future Memorial where we hope visitors from across the nation will come to reflect and **REMEMBER** those we lost on May 18, 2018. The design process required thousands of hours of thought, **CARE** and planning as the Memorial is deeply personal to the Family Directors that serve on our board and individuals from the community and school district that were friends, classmates, coaches, teachers, or colleagues of the **TEN**. Although a challenging process, our focus never wavered in our core mission to **HONOR** the Ten.

The Memorial will stand in the **HEART** of Santa Fe on sacred ground where the families, survivors and community come together in interwoven, infinite loops symbolizing the everlasting

LEGACY and **LOVE** of the Ten. We are deeply grateful for the University of Houston Law Center's Entrepreneurship and Community Development Clinic (ECDC), the University of Houston Gerald D. Hines College of Architecture and Design Build Studio, and Jones Day law firm for contributing their time and expertise to help make our vision one step closer to reality.

Although great progress has been made, there is still much work to be done. The development of the Memorial will not be possible without engagement from the **COMMUNITY** as we partner with the families, individuals, businesses, and organizations to pursue our mission of building a lasting **TRIBUTE** unlike any other Memorial in existence.

Megan L. Grove, Chair

OUR BOARD

Family Directors

SHANNAN CLAUSSEN

Christian Riley Garcia's Mother

GAIL MCLEOD

Kyle McLeod's Mother

ROSIE STONE

Chris Stone's Mother

ROBIN TREAT

Angelique Ramirez's Mother

Community Directors

CAROLYN ADAMS

Retired Teacher
Secretary

CAROL GAYLORD

Mortgage Broker
Treasurer

MEGAN GROVE

Faculty Associate
Chair

School Directors

JARED FAUST

Teacher and Coach

BETH YORLANO

Lead Counselor

OUR MEMBERS

DJ CLAUSSEN

Christian Riley Garcia's Father

SADIE BAZE

Shana Fisher's Mother

STEVE PERKINS

Ann Perkin's Husband

JOLEEN COGBURN

Sabika Sheikh's Host Mother

CHRIS STONE

Chris Stone's Father

MERCEDEZ STONE

Chris Stone's Sister

JENNIFER TISDALE

Cynthia Tisdale's Daughter in Law

LENA CASTRO

Teacher

ANGELICA STONE

Chris Stone's Sister

We are grateful for the support of numerous volunteers from the district and community at large that assist the Foundation.



Our mission is to design and build a memorial that remembers, honors, and celebrates those who died and all individuals impacted on May 18, 2018 in the Santa Fe High School shooting.

Our vision is to inspire hope and resilience through remembrance and educational opportunities.

We also perform other charitable acts in honor of the Ten.

ACCOMPLISHMENTS



2019

ESTABLISHED NONPROFIT

501(c)(3) charitable status was granted with support from the University of Houston Law Center's Entrepreneurship and Community Development Clinic.

2020

SANTA FE TEN MEMORIAL DESIGN

The final concept design submitted by the University of Houston Gerald D. Hines College of Architecture and Design faculty and students was approved by the Santa Fe Ten Memorial Foundation and the Santa Fe Independent School District Board of Trustees.

2021

THE UNFILLABLE CHAIR

Santa Fe High School students from the Class of 2018 – 2021 designed and dedicated a stand alone remembrance piece in honor of their teachers and classmates.

RUN IN REMEMBRANCE

The first annual 5K run/walk brought the community together during the third anniversary of the tragedy.

OTHER CHARITABLE ACTS

The Foundation supported other acts of kindness by sponsoring Capture the Class, Senior parking spots, birthday tributes, and assisted families' efforts to establish legacy scholarships in their loved ones names.

the unfillable chair

DESIGNED AND DEDICATED BY
SANTA FE HIGH SCHOOL STUDENTS
CLASS OF 2018 - 2021
ON THE
THREE YEAR ANNIVERSARY
MAY 18, 2021



For those that have experienced the loss of a loved one, there is a void in their lives that is palpable. Whether it is at school, at the dining table, or an important gathering -- it is evident there is an empty space.

The Unfillable Chair represents that absence. It is place where no one else can sit. It is a space that no one else can fill.

"I never want their names forgotten." -- SFHS student Chailyn Gillespie



"I will carry love for those we lost on May 18 in my heart for the rest of my life..." -- SFHS alumni Reagan Gaona

Photo above from left to right: Morgan Wilson and Chailyn Gillespie (Class of 2021), Reagan Gaona (Class of 2020), Corrigan Garica (Class of 2018), and Maegan Huddleston (Class of 2019).

Five Santa Fe High School students and alumni from the Class of 2018 - 2021 designed The Unfillable Chair to be built as a precursor to the larger planned Memorial.

The students started the design process with each of their own renderings. They then met with members of the community, the Santa Fe Ten Memorial Foundation, family members, and professionals from National Signs to choose the best elements of each proposal and develop a final meaningful and elegant piece.

Photo on right from left to right: National Signs representatives Matthew Nicolay, Katherine Garrett and Cody Johnson.



McLeod Family

Kyle's mother, Gail, stands in the rain. Watching nature's tears fall upon the Ten names.

Gail stated the remembrance piece means to her, "I'm never going to be able to sit anywhere with my son again. I'm never going to have him sit down with me and tell me all the important details of his life."



Tisdale Family

Cynthia's daughter in law, Jennifer, and granddaughters, Kayla and Bailey, joined Santa Fe High School students at The Unfillable Chair on dedication day.

Skufca Family Foundation

Our most heartfelt thanks to Trustees Jack and Lynn Skufca for their generous contribution that helped fulfill the Santa Fe High School students' vision of remembrance and afforded The Unfillable Chair to stand before you today.



FIND OUT MORE

ON OUR WEBSITE

<https://www.sftenmemorial.org/the-unfillable-chair>



10 Feathers

Ten green and gold tipped white feathers, each with a victims' name, were placed in a headdress and seated in the empty chair by the student designers on dedication day. Yet another reminder the lives lost would forever be part of the Santa Fe High School community.

10 Remembrance Rocks

Visitors leave personalized items and hand crafted mementos at The Unfillable Chair underneath the crossed arrows representing the Roman numeral Ten.



Win For 10

SFTX display their championship trophy from the It Takes A Tribe Kickball tournament with the names of the 8 students and 2 educators.

OR SOCIAL MEDIA

Facebook, Instagram and Twitter @SFTenMemorial



Santa Fe High School students and alumni gather at The Unfillable Chair at the dedication ceremony on May 18, 2021.



IN LIFE WE LOVED YOU DEARLY.
 IN DEATH WE LOVE YOU STILL.
 IN OUR HEARTS YOU HOLD A PLACE...
 NO ONE COULD EVER FILL.



**At night, a beacon of light
illuminates the darkness
from within, recognizing
Ten kindred spirits that the
students of Santa Fe High
School will never forget.**

The Unfillable Chair lit up for
the first time at 8:17 pm on
the three year anniversary.
5.18.2021

Jared Conard Black
Shana Fisher
Christian Riley Garcia
Kyle McLeod
Ann Perkins
Angelique Ramirez
Sabika Sheikh
Chris Stone
Cynthia Tisdale
Kimberly Vaughan

CAPTURE THE CLASS

SIGNED BY THE SFHS SENIOR CLASS

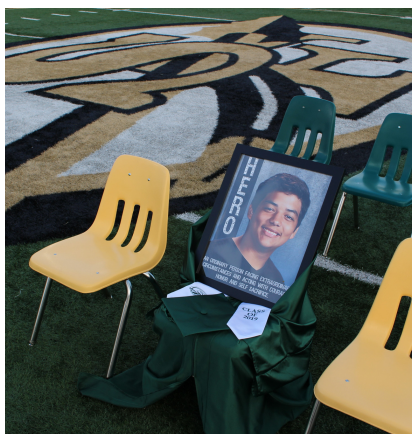

THE LAST CLASS PRESENT THAT TRAGIC DAY

SENIOR PARKING SPOTS



CREATED WITH LOVE AND CARE

Our focus is on the celebration of life and memory of the Ten individuals lost by those that knew and loved them best and not the tragic event itself. A personalized flower or memento will be placed at The Unfillable Chair on each of the victims' birthdays.

A simple, yet powerful, reminder that will stand as a moving tribute of personal loss yet honor the days they touched our lives.

birthday tributes

PRESENTED BY SANTA FE HIGH SCHOOL STUDENTS



ORDINARY PEOPLE CAN DO EXTRAORDINARY THINGS

CONGRESSIONAL MEDAL OF HONOR YOUNG HERO AWARD

FOR ACTS OF COURAGE AND BRAVERY ABOVE AND BEYOND

*POSTHUMOUS

SANTA FE, TEXAS

**CHRISTIAN
RILEY GARCIA ***



2020 HONOREE

CHRIS STONE *



2021 HONOREE

**TRENTON
BEAZLEY**



2021 FINALIST

Christian Riley Garcia was selected for his courageous act when he sprang into action when a gunman opened fire on first period art classes at Santa Fe High School. Christian did not survive the attack but is hailed a hero for his actions.

Chris Stone was selected for his extreme valor when he used his body as a barricade on May 18, 2018 to keep a school shooter from entering a room, saving the lives of many students while losing his own.

Trenton Beazley saved a fellow student with his quick and unselfish actions by making and using a tourniquet to stem the flow of blood from a gunshot wound.



IN ORDER FROM LEFT TO RIGHT: Jason Logan (Adjunct Professor and Principal, LOJO Architecture), Brian Liu, Tiffany Thai, Pear Siriko, Montse Bribiesca, Vanessa Beckett, Josh Rodriguez, Courtney Warren Williams, Hannah Hemmer, Patrick Peters (Professor of Graduate Design/Build Studio and LEED AP Architect)

UNIVERSITY of HOUSTON

GERALD D. HINES COLLEGE of ARCHITECTURE and DESIGN

**THANK YOU TO THE UH FACULTY AND STUDENTS FOR
HELPING COMMEMORATE THE LIVES OF THOSE WE LOST BY
CONCEPTUALIZING SUCH A THOUGHTFUL AND INSPIRATIONAL
MEMORIAL.**



"There are moments in our history that are difficult to honor in design, Though the tragedy that inspired the memorial for the Santa Fe Ten is something one would hope never happens again, we are humbled and forever touched by the family and committee that allowed us to work with them."
-- UH student Hannah Hemmer

"Collaborating with our communities is core to our mission, This has been a transformative experience for our students and faculty who have worked alongside community leaders and families of the victims to design a lasting and inspiring memorial for the Santa Fe community." -- Patricia Oliver, FAIA, Dean of the UH Hines College



WE COME HERE TO REMEMBER

*AN ORDINARY SCHOOL DAY IN MAY.
A DAY OF HONOR FOREVER.*

SANTA FE TEN MEMORIAL

THE OVERALL SITE PLAN

After the tragedy, families, friends, survivors, citizens of Santa Fe, neighboring community members and all individuals impacted needed a thoughtful and respectful space for reflection. The journey of each visitors collective healing, remembrance and resiliency is captured in the overall plan of the Santa Fe Ten Memorial, which is intended to be built on sacred ground and visible from Highway 6.

The entrance to the memorial from the community parking lot will be marked by the identity bench on the left and donor bench on the right. A second entrance will be connected to the teardrop parking lot.

THE MEDITATIVE GROVE

One first enters the memorial through the Meditative Grove. The never ending loop allows one to enter the space intended for reflection, introspection, and to prepare oneself for entrance into the Sacred Space. Here, both the survivors and community come together in interwoven infinite loops that symbolize the everlasting legacy and spirit of the Ten.



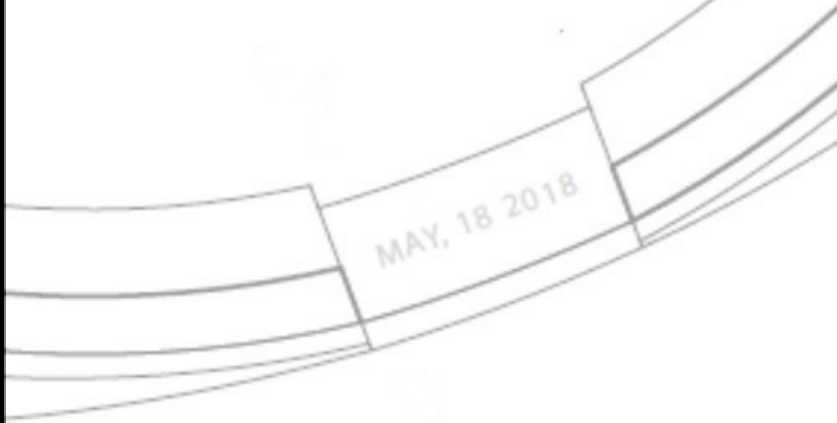
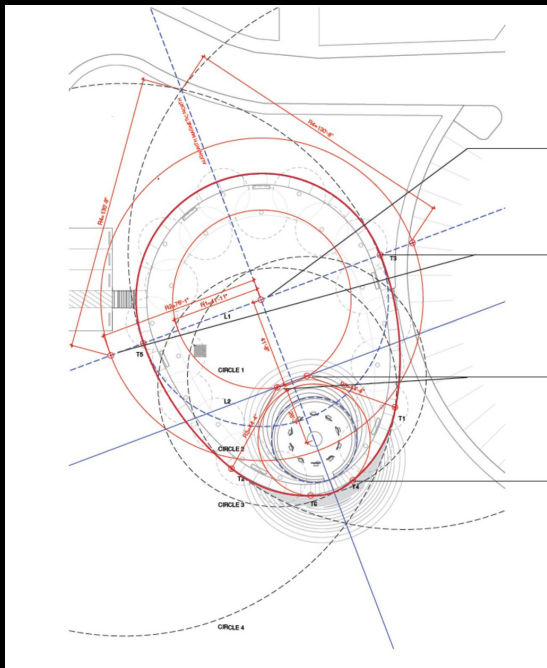

“My hope is our Memorial allows visitors to see and feel how incredibly loved, special, one of a kind, and amazing each one of our angels were while they were here with us.”
-- Robin Treat, Angelique Ramirez’s mother



THE GATEWAY

When you are ready to visit the Sacred Space, the path begins to narrow. Along the right of the wall, you read the dedication and the left will be inscribed with “We Come Here To Remember.” The break in the retaining wall marks the entrance. At this threshold, the date “May 18, 2018” is carved in stone inlaid in the ground.

THE GEOMETRICAL PLAN

The base concept of the Memorial is designed from consecutive infinity loops representing timelessness.

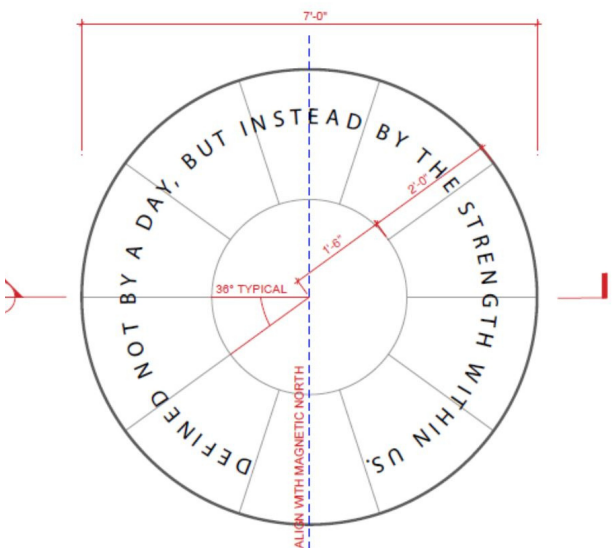

THE CENTER STONE

The inspirational phrase “Defined not by a day, but instead by the strength within us,” was selected from more than 50 submissions and will be incorporated into the center stone of the Santa Fe Ten Memorial.

1 CENTER STONE
 1" = 1'-0"

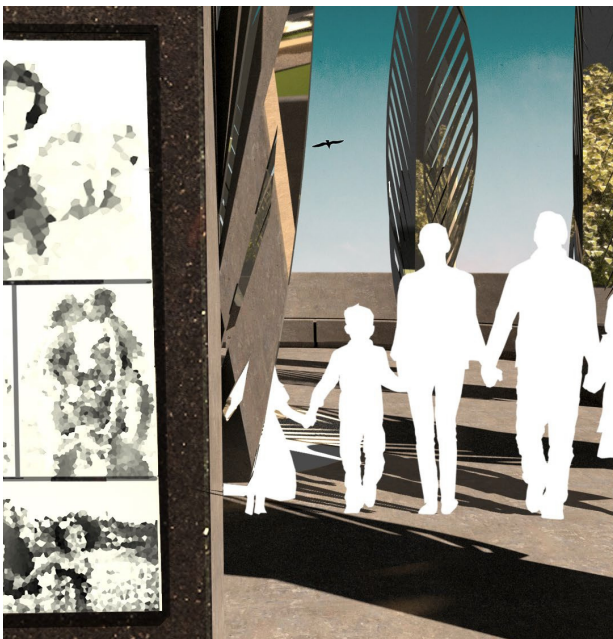
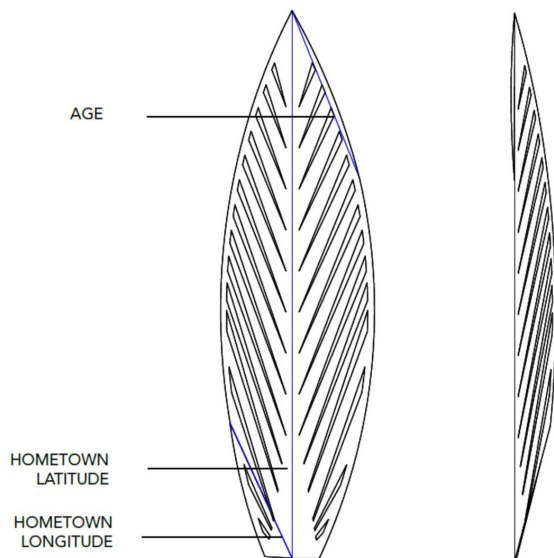
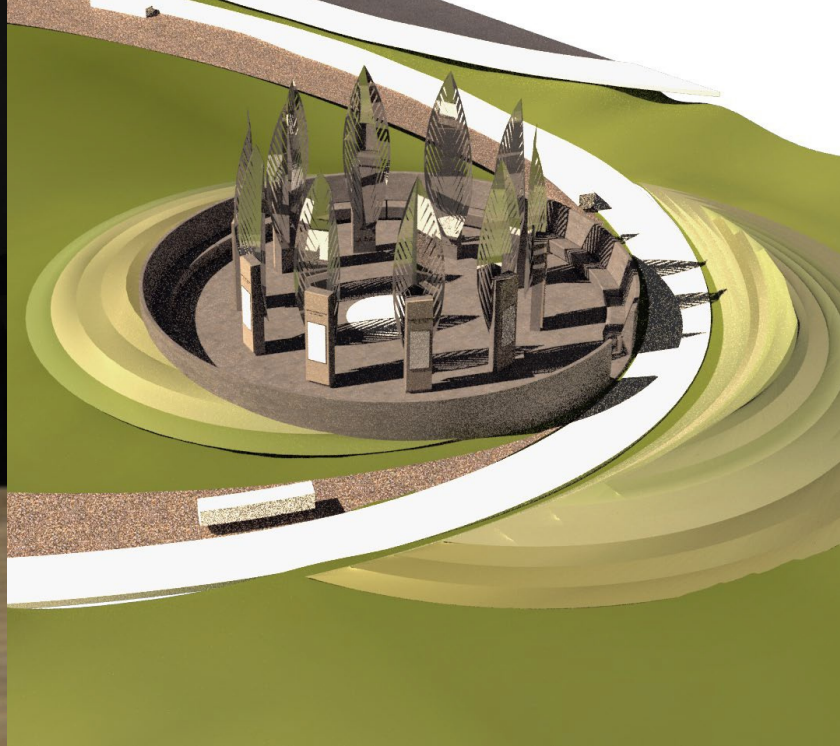
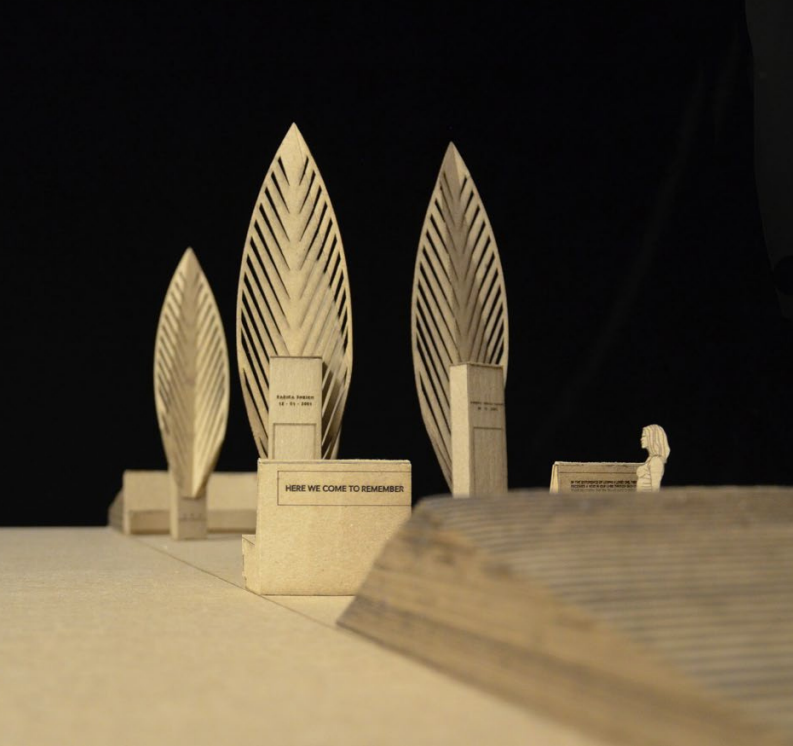

THE SACRED SPACE

Ten monuments honor each individual lost and create a central void which can never be filled. As you travel through the space at your own pace, you will come to know the Ten that live on in the hearts of many.

THE RISING FEATHERS

Each concrete monolith encased by granite holds a uniquely shaped feather for each individual, which will be folded by the age and birthplace or hometown coordinates (in degrees latitude and longitude) creating a monument unlike any other.

THE PERSONALIZED AREA

Each of the Ten's monuments is adorned with personal memories from the families so that visitors will know more about each individual's life and how they impacted others with their kindness, compassion, and courage.

"The Memorial will serve as a place where the Ten will forever be remembered."
-- Rosie Stone, Chris Stone's Mother

9/11 MEMORIAL & MUSEUM

Chairman

Michael R. Bloomberg
108th Mayor,
City of New York

Honorary Trustees

George W. Bush
43rd President of the
United States

Jimmy Carter
39th President of the
United States

William J. Clinton
42nd President of the
United States

Barack Obama
44th President of the
United States

Honorary Chairman

George E. Pataki
53rd Governor,
State of New York

Honorary Trustees

Andrew M. Cuomo
56th Governor,
State of New York

Rudolph W. Giuliani
107th Mayor,
City of New York

Philip D. Murphy
56th Governor,
State of New Jersey

Trustees

Virginia S. Bauer

Paula Grant Berry

Frank Bisignano

Debra Burlingame

John P. Cahill

Russell L. Carson

Kenneth I. Chenault

Ric Clark

H. Rodgin Cohen

Keating Crown

Billy Crystal

Robert De Niro

Samuel A. DiPiazza, Jr.

Richard Edelman

Christine A. Ferer

Roger W. Ferguson, Jr.

Anne Finucane

Jennifer Glick

Maurice R. Greenberg

Patricia E. Harris

Robert Iger

Monica Iken

Jeh Johnson

Thomas S. Johnson

Anthoula Katsimatides

Peter M. Lehrer

Howard W. Lutnick

Joel S. Marcus

J. Kevin McCarthy

Adm. Bill McRaven, USN (ret.)

Julie Menin

Ira M. Millstein

Howard Milstein

Joseph Moinian

Paul Napoli

Terence M. O'Toole

Emily K. Rafferty

Kevin M. Rampe

Scott Rechler

Terri J. Richardson

Thomas H. Rogér

Jane Rosenthal

E. John Rosenwald, Jr.

Andrew M. Senchak

Jerry I. Speyer

Craig Roberts Stapleton

Jon Stewart

Anne M. Tatlock

Daniel R. Tishman

Seth Waugh

Jeffrey S. Wilpon

President & CEO

Alice M. Greenwald

Founding Chairman

John C. Whitehead

(1922-2015)

July 27, 2021

Ms. Megan Grove

Chair

Santa Fe Ten Memorial Foundation

P.O. Box 919

Santa Fe, TX 77510

Dear Megan,

On behalf of the National September 11 Memorial & Museum, I would like to offer our ongoing support as your community continues to heal from the horrific events that took place at Santa Fe High School in May of 2018.

Our community is well aware of the challenges of recovery after immense tragedy, and of the continued pain and devastation such senseless attacks cause for those directly affected. I hope that you all find comfort in the expressions of compassion and solidarity from across the country and around the world, affirming that human dignity will always triumph over human depravity.

In recognition of our shared strength, the 9/11 Memorial wishes to present the Santa Fe Ten Memorial with a Callery pear tree, grown from the seeds of the 9/11 Memorial's own Survivor Tree. The Survivor Tree is a living reminder of resilience, survival, and rebirth. It stood on the original World Trade Center Plaza, and on September 11, 2001, the tree was nearly destroyed. With time and care, it was nursed back to health, and today it stands as a symbol of strength and renewal at the Memorial, where it is seen by millions of people each year.

Through our Survivor Tree seedling program, the 9/11 Memorial annually donates these seedlings to communities like Santa Fe that have faced and overcome tragedy. The program launched on September 11, 2013, and we have thus far recognized 24 communities that have demonstrated resilience in the face of adversity.

I hope that the Santa Fe Ten Memorial will accept this Survivor Tree seedling into your community as a symbol of healing, just as the tree itself has been for New York City. My office will be in touch with your staff shortly to discuss further details. Please do not hesitate to contact me directly at [REDACTED], should you have any questions.

Very truly yours,

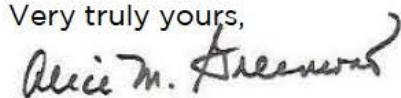

Alice M. Greenwald

President & CEO

NATIONAL SEPTEMBER 11 MEMORIAL & MUSEUM AT THE WORLD TRADE CENTER

200 LIBERTY STREET, 16TH FLOOR, NEW YORK, NY 10281 P: (212) 312-8800 F: (212) 227-7931

911MEMORIAL.ORG

We Come Here To Remember

SANTA FE TEN MEMORIAL

"This tree will be a symbol of not only remembrance, but growth. Not only of commemoration, but progression. As the branches of our new gift continue to grow, our community will grow with them, each generation of students being their own branch, paving the way to a hopeful future." Mckinsey Criss, Santa Fe High School student & Club Hope President

9/11 SURVIVOR TREE SEEDLING 2021 HONOREE



Photos courtesy of the 9/11 Memorial & Museum and New York Department of Parks and Recreation

TRAGEDY

A Callery pear tree
once stood in World Trade Center
Plaza where it was nearly destroyed on
September 11, 2001.

RECOVERY

The tree that survived
was nursed back to health for 9 years
before it was replanted near the South
Pool in the 9/11 Memorial Plaza.

RENEWAL

This gift of nature
represents a healing promise of hope
and the unshakeable spirit of growth
and renewal that define our city.

A living monument and national landmark of hope and resilience in our community that will be cared for by SFHS students and recognizes the strength of those that lost loved ones, courage of those who survived, and salutes those who risked their lives to help others.

donate & info

Help us build a place of tribute to the Ten
and a space of healing for the community.

www.sftenmemorial.org/the-911-survivor-tree

   @SFTenMemorial

RUN IN REMEMBRANCE 2021

A day of remembrance. A day of honor.
Never forget the Santa Fe Ten.
Our 1st annual event held on May 22
at Jack Brooks Park.



SEE YOU NEXT YEAR!

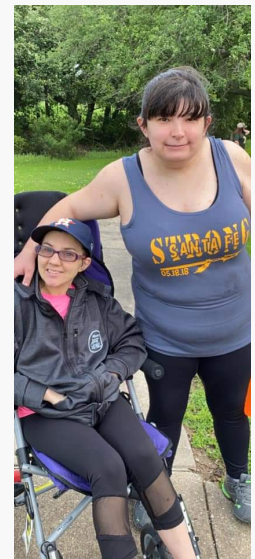

THANK YOU TO OUR SPONSORS

AMOCO
FEDERAL CREDIT UNION
"A Member Owned Cooperative Organization"

all about you™



TEXAS FARM BUREAU
INSURANCE
AUTO / HOME / LIFE

THANK YOU



The Santa Fe Ten Memorial will not be possible without the generosity of benefactors who wish to honor and commemorate the humanity and individualism of Ten lives lost that tragic day and recognize the selflessness of first responders and recovery of survivors.

**\$50,000+
Level**

-- Skufca Family Foundation | Trustees Jack and Lynn Skufca
-- University of Houston Gerald D. Hines College of Architecture and Design*

**\$25,000 -
\$49,999
Level**

--

**\$10,000 -
\$24,999
Level**

-- Jones Day*
-- University of Houston Law Center's Entrepreneurship and Community Development Clinic (ECDC)*
-- Walmart | 10 El Paso Stores (In memory of the 23 victims that lost their lives in the August 1, 2019 tragedy) | LaMarque | Galveston | Sam's Club LaMarque

**\$1,000 -
\$9,999
Level**

-- Amegy Bank | Santa Fe, TX
-- Arrowhead Electric, Inc.*
-- Eye Appeal Design | Brenda Holley*
-- Executive Board of the Santa Fe Texas Education Foundation
-- Gulf Coast Aerobic Services | John Wilson*
-- Hart 2 Heart Stitching and Design
-- Paula and Blackie Heileman
-- Los Carnales & La Familia Motorcycle Club of Galveston County
-- Marisel Meljen | In memory of her daughter - Angelica Meljen
-- Santa Fe Dental Associates | Dr. Frank Bonno
-- The Green Tree Fund | Nancy Allen
-- Elizabeth Tenbrook | In memory of her grandson - Kyle McLeod

**denotes in-kind value*

LOOKING FORWARD

HELP US
RAISE

1.4
MILLION

FOR THE FUTURE

"For us left, our work is not done."

-- Shannan Claussen, Christian Riley
Garcia's Mother

INDIAN STATUE



- The Foundation is soliciting original proposals for a custom designed statue tentatively to be completed in 2022

- Guidelines for submitting a proposal and design are available on our website at <http://www.sftenmemorial.org/the-indian-statue>

EVENTS



- Events are continuously updated on our website at <https://www.sftenmemorial.org/events>

- The Run in Remembrance will be an annual event held in May

SUPPORT



- Monetary donations are accepted in multiple formats - cash deposits at Amegy Bank, Venmo, Facebook, PayPal, and via debit or credit card on our website

- If you have materials or expertise that could be used to build the Memorial, or would like to volunteer to help at an event, please contact us via email at sftenmemorialfoundation@gmail.com

FINANCES



- We believe in fiscal transparency and operate under the core values of rigor, ethics, dignity, integrity, competence and resilience

- Our revenue and expenses are publicly available on our website

- Reports are prepared annually which summarize our accomplishments each fiscal year

· SANTA FE TEN MEMORIAL FOUNDATION ·

CONTACT US

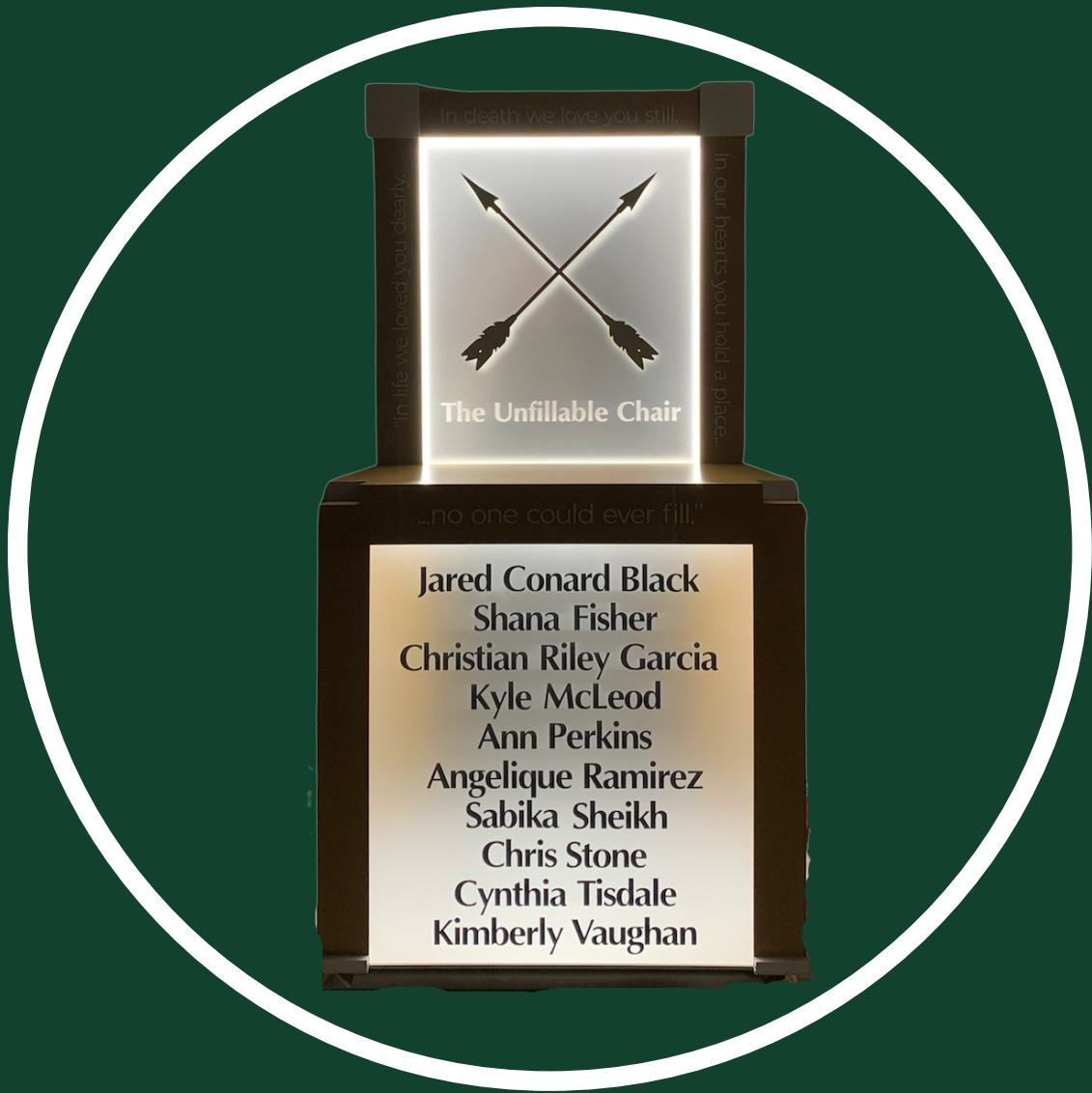

PO Box 919, Santa Fe, TX 77517

EMAIL: sftenmemorialfoundation@gmail.com

DONATE at our website

WWW.SFTENMEMORIAL.ORG